



# INSTALLATION MANUAL

## A-2642 Arnott Rear Air Spring BMW X5 (E70/F15) & BMW X6 (E71/F16)



INSTALLATION VIDEO

<https://bit.ly/4uODtrq>



**Engineered to Ride, Built to Last<sup>®</sup>**

# CONGRATULATIONS ON YOUR PURCHASE OF AN ARNOTT® SUSPENSION PRODUCT

WE AT ARNOTT LLC ARE PROUD TO OFFER A HIGH QUALITY PRODUCT WITH ALL THE TECHNICAL SUPPORT YOU NEED. THANK YOU FOR YOUR CONFIDENCE IN US AND OUR PRODUCT.

Proper installation is essential to experience and appreciate the benefits of this system. Please take a moment to review these installation instructions before you begin to install these components on your vehicle. The removal and installation of air suspension products should only be performed by a fully qualified and certified automotive professional.

It is equally important to be aware of all necessary safety measures while installing your new Air Suspension System. This includes proper lifting and immobilizing of the vehicle and isolation of any stored energy to prevent personal injury or property damage.

## GENERAL INFORMATION

Reading this manual signifies your agreement to the terms of the general release, waiver of liability, and hold harmless agreement, the full text of which is available at [www.arnottsuspension.com](http://www.arnottsuspension.com) and [www.arnotteurope.com](http://www.arnotteurope.com).



### WARNING:

The air suspension system is under pressure (up to 10 bar, or 150 lbf/in). Verify pressure has been relieved and disconnect power to the air suspension system prior to disassembly. Do not allow dirt or grease to enter the system. Always wear standard hand, ear, and eye protection when servicing the air suspension system.

- Not to be stored below 5°F (-15°C) and above 122°F (50°C).
- Avoid damage to air lines and cables.
- Removal and installation is only to be performed by fully qualified personnel.
- Use car manufacturer's diagnostic software.

### CAUTION:

Damage to the vehicle and air suspension system can be incurred if work is carried out in a manner other than specified in the instructions or in a different sequence.

To avoid the possibility of short circuits while working with electric components, consult your owner's manual on how to disconnect your battery.

Consult your vehicle owner's manual, service manual, or car dealer for the correct jacking points on your vehicle and for additional care, safety and maintenance instructions. Under no circumstances should any work be completed underneath the vehicle if it is not adequately supported, as serious injuries and death can occur.

For vehicles with a "Closed Air Supply System," replacement of components requires proper adherence to procedures set forth within OE servicing literature. Failure to comply with the OE prescribed procedures can result in component damage and/or failure.

# AIR SPRING REMOVAL

1. Set the steering to straight ahead.
2. Raise the vehicle.
3. Deflate and disable the air suspension system according to the manufacturer's procedures.
4. Remove the rear wheel. (Figure 1)



FIGURE 1

5. Remove the bottom piston from the lower air spring seat by pressing in the two locking tabs and pushing upward on the bottom piston. (Figures 2, 3)



FIGURE 2



FIGURE 3

6. Remove the top of the air spring by turning counterclockwise approximately 90 degrees, and pull the air spring out. (Figures 4, 5)



FIGURE 4



FIGURE 5

7. Remove the air line from the air spring. Remove the air line fitting and discard. (Figures 6, 7, 8)



FIGURE 6

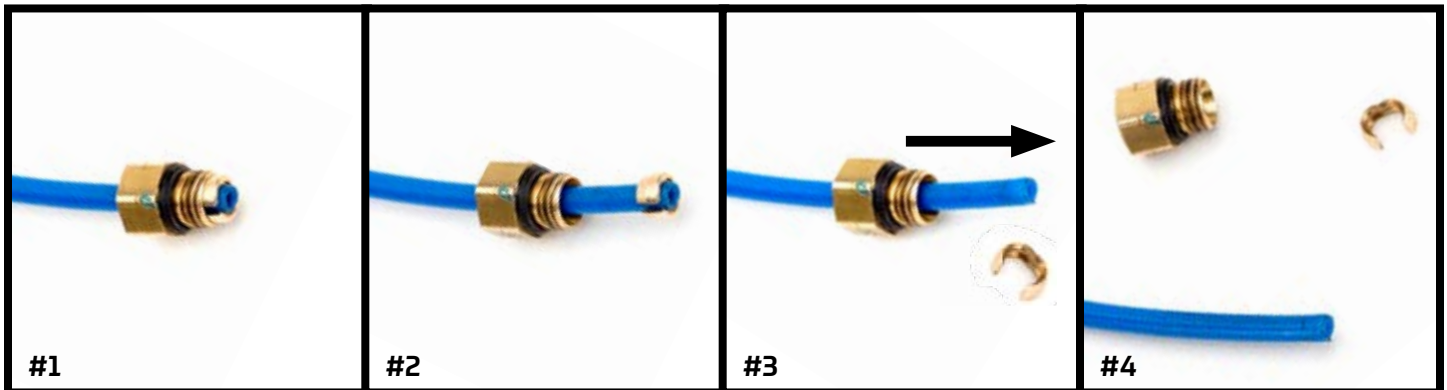

FIGURE 7

### AIR LINE FITTING REMOVAL



Prior to inserting the existing air line into the new air strut, remove the old original equipment air line fitting and discard.



#1

OE AIR LINE FITTING

#2

SLIDE THE THREADED PORTION UP THE LINE AND SPREAD THE COLLET OPEN TO REMOVE

#3

SLIDE THE AIR FITTING OFF OF THE AIR LINE

#4

DISCARD OE AIR LINE FITTING

FIGURE 8

8. Removal complete.

# AIR SPRING INSTALLATION



**WARNING:**

Tighten all nuts and bolts to the manufacturer's specifications during the installation process.



**WARNING:**

Do not remove the air fitting from the air spring. Doing so may cause damage and/or void warranty. Remove the white shipping pin from the new air fitting and insert the air line until fully seated.

1. Install the air line into the new Arnott air spring. (Figures 9, 10)

## SHIPPING PIN REMOVAL AND AIR LINE INSTALLATION

**NOTE:** Scratches and/or deep cuts in the air line may result in leaks. Inspect the air line before insertion. Replace the air line if damaged.

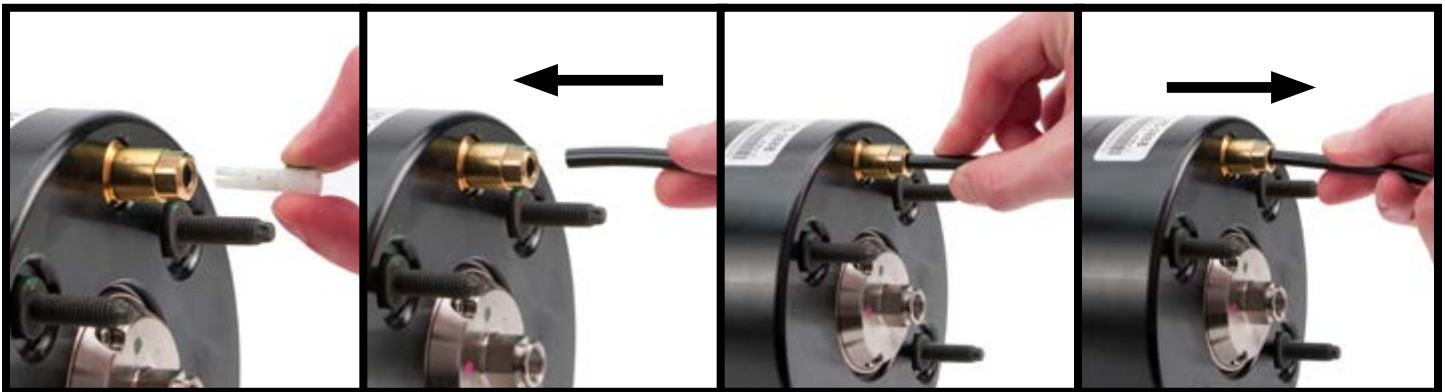

REMOVE AND DISPOSE OF THE SHIPPING PIN.

INSERT AIR LINE INTO THE AIR LINE FITTING UNTIL IT STOPS.

AIR LINE INSERTED.

GENTLY PULL ON AIR LINE TO CONFIRM IT IS FULLY SECURED BY THE AIR LINE FITTING.

FIGURE 9



FIGURE 10

2. Once the air line is installed, gently route the air line into the dedicated slot in the top mount. (Figure 11)



FIGURE 11

3. Install the air spring into the vehicle. Position the top of the air spring in the upper mount. Rotate into the locked position so that it is fully seated in the upper mount by turning approximately 90 degrees clockwise. (Figures 12, 13)



FIGURE 12



FIGURE 13

4. Make sure that the air spring is properly oriented with the lower seat. Then, press the bottom piston into the lower air spring seat until both locking tabs engage.

**NOTE:** You should be able to feel and hear the bottom piston click into place in the lower spring seat.



FIGURE 14



FIGURE 15



**WARNING:**

Ensure both the top and bottom of the air spring are securely locked into place before proceeding.

5. Enable and reinflate the air suspension system according to the manufacturer's procedures.
6. Reinstall the rear wheel.
7. Lower the vehicle.
8. Installation complete.



**HOW HELPFUL WAS THIS MANUAL?**

Scan the QR code or click the link below to let us know.

<https://bit.ly/4dpUdyB>

**NEED IMMEDIATE SUPPORT?**

We're happy to help! Reach out using the contact information listed.

# Arnott®

## Suspension Products

### Arnott US Business Office:

[www.arnottsuspension.com](http://www.arnottsuspension.com)

100 Sea Ray Drive  
Merritt Island, FL 32953

**Call:** 800.251.8993  
321.868.3016

**Fax:** 321.868.3703

**Email:** [techassistance@arnottinc.com](mailto:techassistance@arnottinc.com)

### Arnott Europe Business Office:

[www.arnotteurope.com](http://www.arnotteurope.com)

Industrieweg 19  
5145 PD, Waalwijk (NL)

**NL Phone:** +31 73 7850 580

**DE Phone:** +31 85 2087 438

**UK Phone:** +44 203 3186 124

**BE Phone:** +32 258 846 90

**ES Phone:** +34 91 901 10 56

**FR Phone:** +32 78 48 46 93

**Email:** [info@arnotteurope.com](mailto:info@arnotteurope.com)

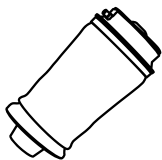

Air Springs

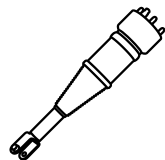

Struts

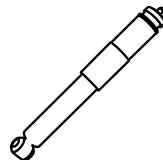

Shocks

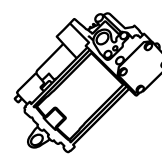

Compressors

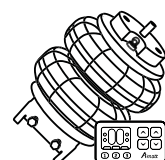

LCV Air Helper  
Spring Kits

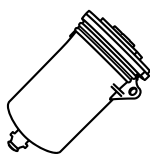

Dryers

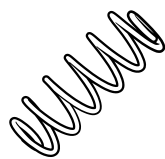

Coil Spring  
Conversion Kits

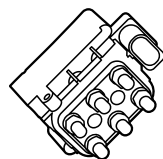

Valve Blocks

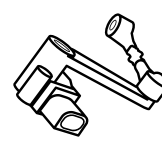

Ride Height  
Sensors

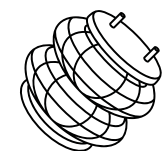

Pickup Truck Air  
Helper Springs