



PI 0023

For technical personnel only!

1/2

# PRODUCT INFORMATION

## FUEL SIEVE FILTER AS A PREFILTER

### FOR TYPE E1F ELECTRIC FUEL PUMPS

Fuel pumps are sensitive to dirt. Fuel pumps wear due to dirt: The pump system may become obstructed and destroy the fuel pump.

Pierburg fuel sieve filters (4.00030.80.0) reliably protect the type E1F fuel pumps against dirt and other foreign particles. The fuel sieve filters therefore prevent the fuel pump from failing prematurely.

For more information on the fuel pumps, please refer to our catalogue or product information PI 0034.



#### ATTENTION

The fuel pumps are supplied with a small protective filter in the suction nozzle. This protective filter must be removed on the E1F diesel fuel pump (7.21440.70.0) as the increased viscosity of diesel at low temperatures will cause problems.

#### NOTE

The fuel sieve filter should be replaced at the same maintenance intervals as the fuel filter.





PI 0023

For technical personnel only!

2/2

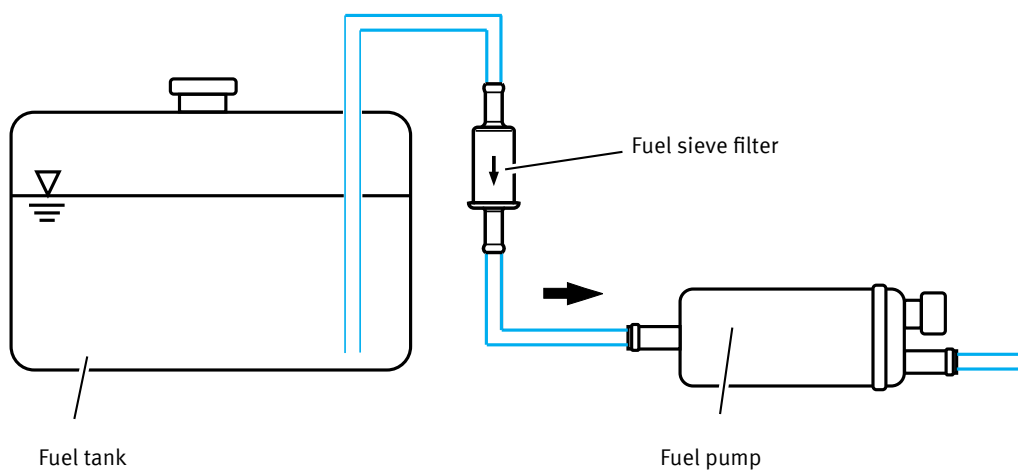

The sieve filters can be installed in the fuel line between the fuel tank and the type E1F fuel pump (with a diameter of 8 mm at the suction nozzle).

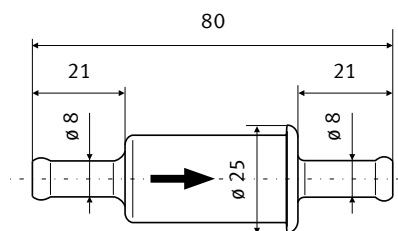

Dimensions in mm

#### Technical data

Filter area	7.6 cm <sup>2</sup>
Mesh size	105 µm
Operating pressure	≤ 2.5 bar