

Cooling



COTB 0001

FWP1113/FWP1696

Heavy Duty Water Pump Options

First Line is able to offer optional updated/heavy duty Water Pumps for VAG applications listed as **FWP1113** (Pump only) / **FWP1696** (inc. Backhousing).

These premium pumps are manufactured to exacting Original Equipment specification incorporating a new 4 point angular contact bearing and a silicon carbide seal.

FWP1113 & **FWP1696** remain available and unaffected by this option.

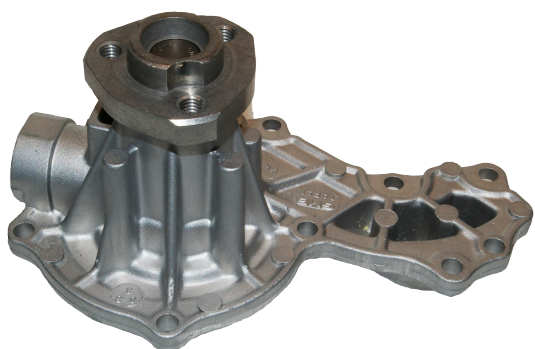

FWP2074

Pump Only
OE ref: 037 121 010C
Optional fitment for FWP1113

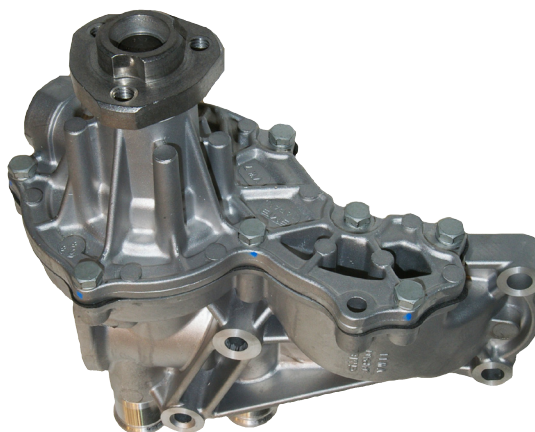

FWP2075

Pump with backhousing
OE ref: 037 121 010C
Optional fitment for FWP1696