



INA Service Info



Coolant pump 538 0314 10

Failure due to additional sealant being applied

Manufacturer: Chevrolet, Opel

Models:

Chevrolet: Aveo, Cruze, Orlando, Trax

Opel/Vauxhall: Adam, Astra, Corsa, Insignia, Mokka

Engines: 1.2, 1.4

Part no.: 538 0314 10

For current listing refer to catalogue media



Fig. 1: 538 0314 10 - Coolant pump with accompanying gasket

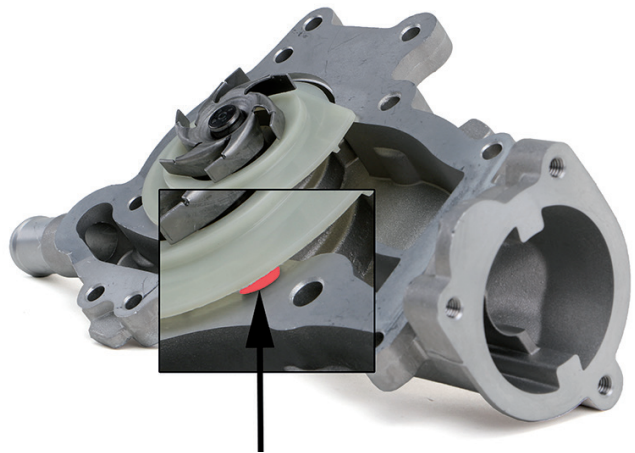

Fig. 2: Distorted plastic shield due to excess sealant

Coolant pump 538 0314 10 is sealed with a gasket. NO additional sealant may be used during installation.

If additional sealant is used during installation, excess sealant is forced between the coolant housing, and the plastic shield that guides the coolant flow (Fig.2), causing it to distort. In operation the shield is forced against the impeller, damaging or completely destroying the shield, which results in coolant pump failure. Fragments of the plastic shield are passed through the cooling system, and can cause consequential damage.

See also Service Information INA 0162.

Please observe the vehicle manufacturer specifications!

You want more? We can help!

Phone: +44 (0) 1432 264 264

Fax: +44 (0) 1432 375 760

aftermarket.uk@schaeffler.com

www.repxpert.co.uk